

- ▶ **High quality micro switches for a wide range of applications**
- ▶ **Excellent performance, high reliability and long service life**
- ▶ **UL/cUL and ENEC certification**
- ▶ **Applications - Automotive (Seat Belt, Door Latch, Engine Hood, Door Trunk), Air Conditioner, Communication, Security System, Electric Tooth Brush, Toy**

**Certification information**

	<b>UL - cUL</b>	<b>ENEC</b>
DW-N2S	10 mA 12 VDC ( Temp : 65°C ) Min. 10,000 operations	10mA 12VDC, μ T55 5E5
DW-N3S	3 A 12 VDC ( Temp:65°C ) Min. 10.000 operations  3A 125 VAC ( Temp:65°C ) Min. 6,000 operations	3A 12VDC, μ T55 1E5

**Dimensions**

Unless otherwise specified, a tolerance of ±0.4mm applies to all dimensions.

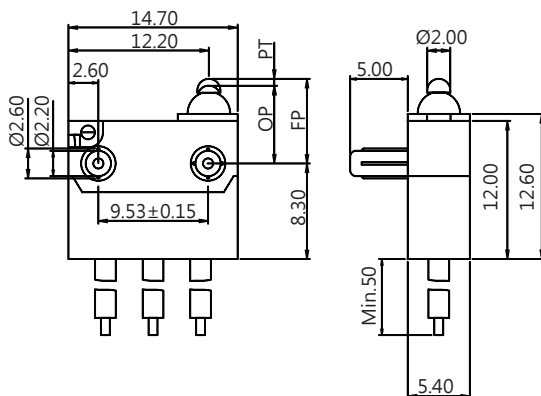



## Ordering information

(Please use the characters in the chart below to create your product code)

**Samplecode**      DW   -   N2   S   -   01   A   Q   -   E   A   -   001A   -   Z

### Rating Current

N2	10mA 12VDC Contact Plated Gold and Terminal Plated Silver
N3	3A 12 VDC

### Actuator Type

00	
01	
04	

### Pillar & Travel Type

Short Travel

A	
B	
C	
G	
I	
K	
M	
P	
R	

### Pillar & Travel Type

'Long Travel

D	
E	
F	
H	
J	
L	
N	
Q	
S	



## Ordering information

(Please use the characters in the chart below to create your product code)

**Samplecode**      DW   -   N2   S   -   01   A   0   -   E   A   -   001A   -   Z

### Circuit Arrangement

0    S.P.D.T.

1    S.P.S.T.NO

2    S.P.S.T.NC

### AWG Type

E    20

F    22

G    24

### UL Number

A    UL 1007

C    UL 1430

D    UL 1061

### Serial Code

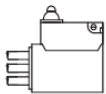

### Dimensions

Please see table below

If you require a customized solution for your program contact our sales team.

## Dimensions

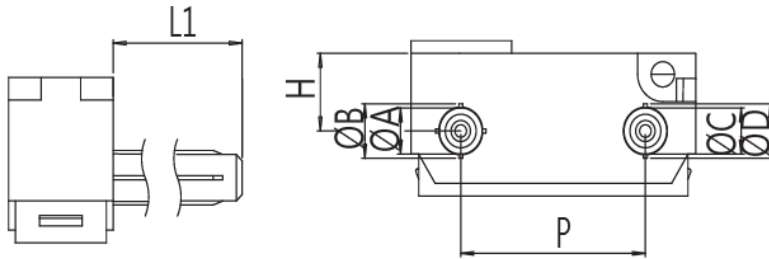

Code	L1	H	A	B	C	D	P
A	2.0	3.7	2.2	2.6	2.2	2.6	9.53
B	3.5	3.7	2.2	2.6	2.2	2.6	9.53
C	2.8	3.75	2.7	3.1 (three ribs)	2.2	2.6	9.53
D	4.0	3.7	2.2	2.6	2.2	2.6	9.53
E	0.9	3.7	2.2	N/A	2.2	N/A	9.53
F	1.8	3.7	2.5	N/A	2.5	N/A	9.53
G	5.0	3.7	2.4	2.8	2.4	2.8	8.0

**Note.:** Safety leads wire min 50mm (20~26 AWG)